

Pool Deck

CAPACITY 32

SQUARE FOOTAGE 572 SQ. FT.

DIMENSIONS 24.4 FT. x 23.9 FT.

Our fifth-floor pool deck provides gorgeous views of downtown Atlanta and over 8,000 square feet of space for your event. Host a luncheon or evening reception next to our pool and Highball bar. Our catering menu has just the right options for you, from finger foods and appetizers to full-course meals. Your guests will love the outdoor air and scenery. Enjoy access to the pool for a summer soirée or keep it classy for a nighttime gathering. Your stylish guestroom is only a short walk away for you to relax after your reception, along with our spa and beauty bar to help you prepare or wind down after a blowout.

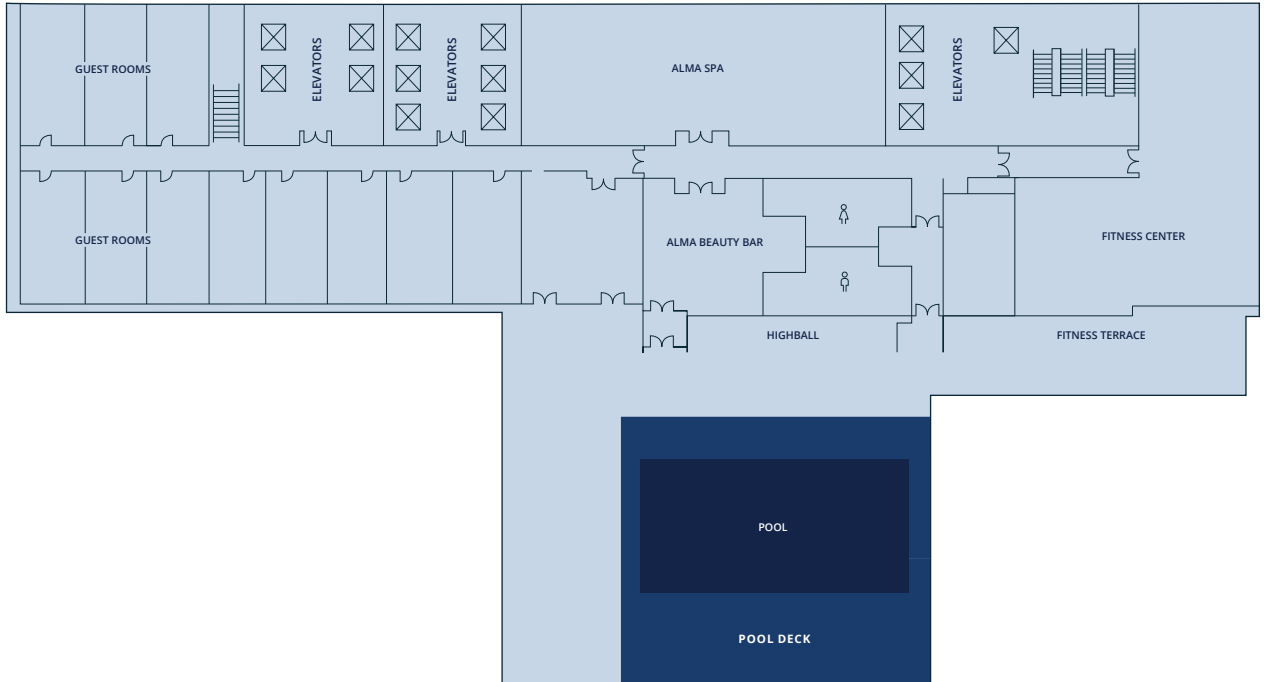

LEVEL FIVE

ROOM	SQ. FT.	CEILING HEIGHT	DIMENSIONS	MAX CAPACITY	U SHAPE	BANQUET ROUNDS	COCKTAIL ROUNDS	THEATER	CLASSROOM	BOARDROOM	HOLLOW SQUARE
Pool Deck	8,051 sq. ft.	1000 ft.	83 ft. x 97 ft.	500	—	—	500	—	—	—	—