

Georgia Ballroom

CAPACITY 2,160

SQUARE FOOTAGE 27,835 SQ. FT.

DIMENSIONS 145.7 FT. x 241.4 FT.

Directly accessible from Level Two of Signia by Hilton Atlanta and the Triumph Ballroom, the Georgia Ballroom is located in Georgia World Congress Center. This ballroom is good for large events or conventions, boasting over 25,000 square feet of space. A large stage and projector screens provide a perfect space for an awards reception or to bring in a speaker. Our staff can help you plan for your big event and will make sure you get to take the time to enjoy your work. After your convention, it's just a short walk back to the hotel to enjoy your luxe guestroom and all the Signia has to offer to you.

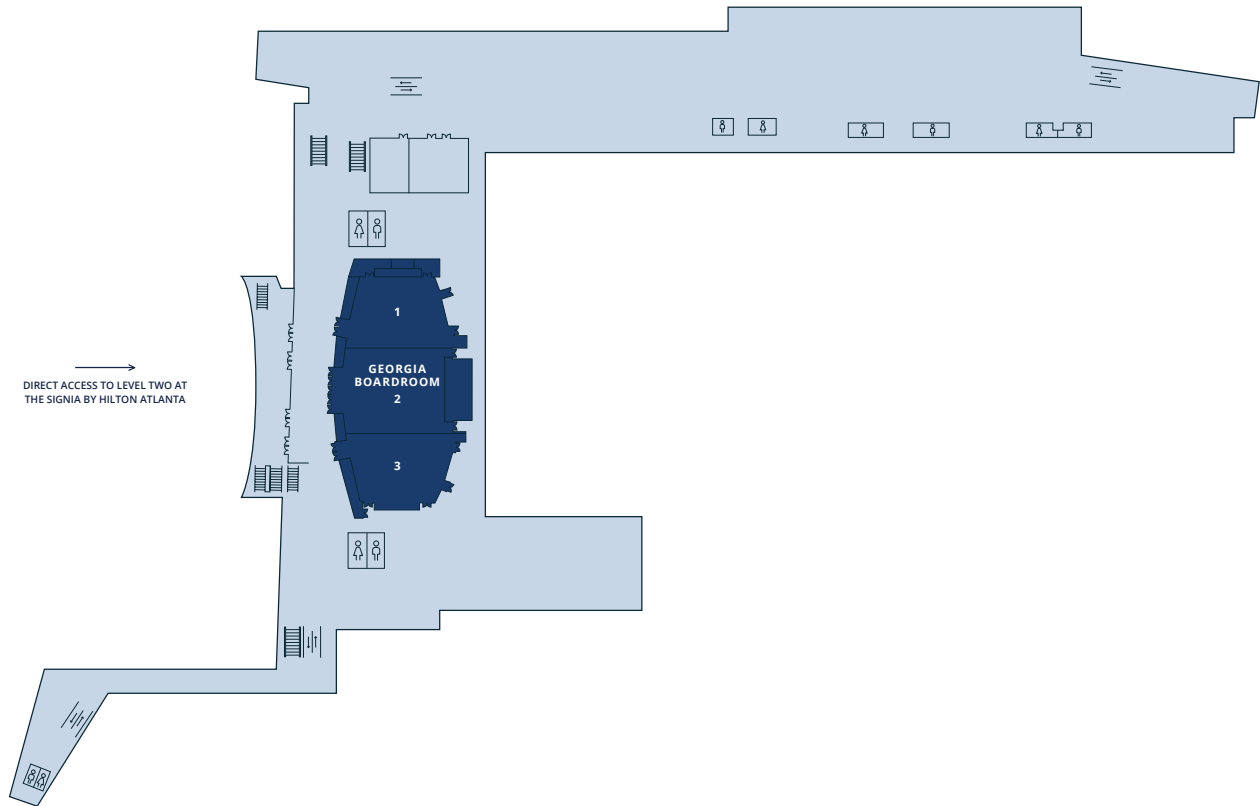

LEVEL TWO GWCC

ROOM	SQ. FT.	CEILING HEIGHT	DIMENSIONS	MAX CAPACITY	U SHAPE	BANQUET ROUNDS	COCKTAIL ROUNDS	THEATER	CLASSROOM	BOARDROOM	HOLLOW SQUARE
Georgia Ballroom	27,835 sq. ft.	40 ft.	145.7 ft. x 241.4 ft.	2,160	—	1,640	—	2,160	1,386	—	—
Georgia Ballroom 1	7,756 sq. ft.	40 ft.	125.7 ft. x 75.2 ft.	680	—	460	—	680	405	—	—
Georgia Ballroom 2	12,300 sq. ft.	40 ft.	145.7 ft. x 91.1 ft.	945	—	560	—	945	528	—	—
Georgia Ballroom 3	7,746 sq. ft.	40 ft.	125.7 ft. x 75.1 ft.	680	—	460	—	680	405	—	—
Georgia Ballroom Galleria	17,345 sq. ft.	40 ft.	103.5 ft. x 341.8 ft.	75	—	—	—	—	—	—	—